

Escutcheon- Surface Mount

ESCUTCHEON

JCP Models Description

J-7-8601 Escutcheon– Double Winged x US32D
(shown on left)

J-7-8602 Escutcheon– Single Winged x US32D
(shown on right)

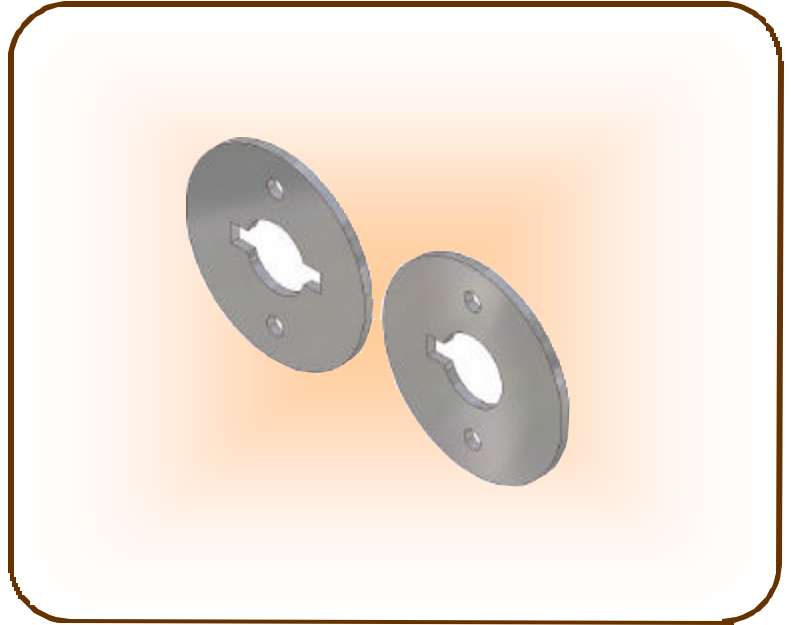

JCP Specifications: The JCP escutcheon is 3” in diameter x 10 gauge stainless steel with a random orbital finish. The application for the escutcheon is to prevent wear around a paracentric key cylinder and to help guide the insertion of the paracentric key into the cylinder. The escutcheon is provided with two (2) Torx® w/ pin security screws. Escutcheons are either double winged for keys that are to be removed in both positions, or single winged for keys that are to be removed only in the locked position as required by the lock function.

Always verify that you have the correct templates for your specific project.



JAILS CORRECTIONAL PRODUCTS A Division of **FABCOR, Inc.**

350 South Ohio Street, P.O. Box 58
Minster, Ohio 45865
www.fabcor.com

Phone: (419) 628- 4428
Fax: (419) 628- 2899
E-mail: jails@fabcor.com

Hardware Assembly

HA-06.01

Revision C

©2003 Fabcor, Inc.